

art. U1540

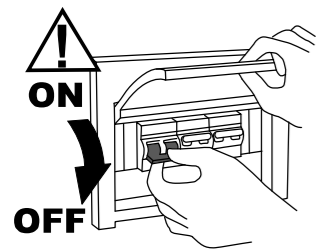

Per evitare di danneggiare il LED effettuare tutti i collegamenti prima di dare tensione
To avoid damages to LED unit all connection shall be made before to switch power on
 Pour éviter d'endommager l'unité LED, toutes les connexions doivent être effectuées avant de mettre sous tension

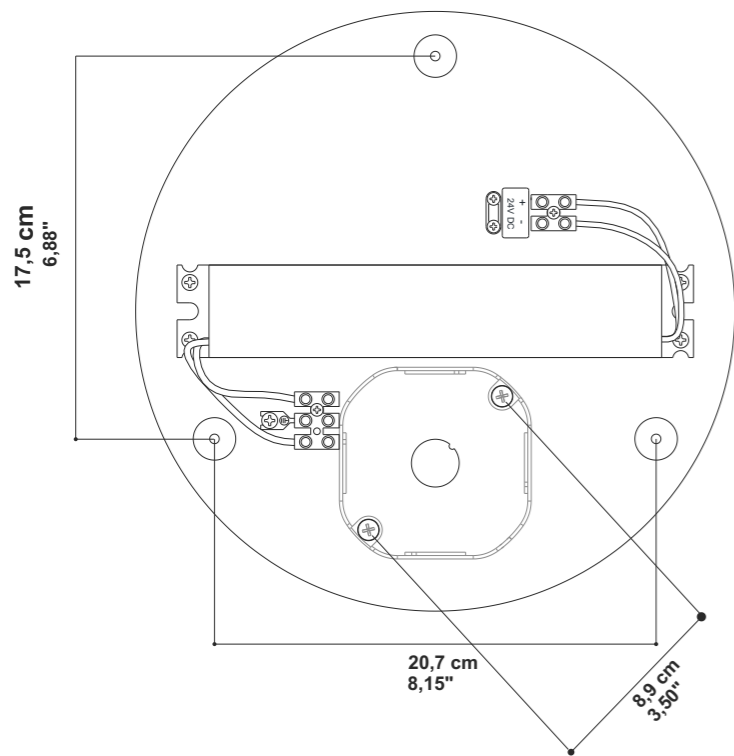

Article code:	a	b	c
U1540. * /100/ **	40,16"	7,87"	24,41"
U1540. * /125/ **	50"	7,87"	34,25"
U1540. * /150/ **	59,84"	11,81"	36,22"
U1540. * /175/ **	69,69"	11,81"	46,06"
U1540. * /200/ **	79,53"	23,62"	32,28"
U1540. * /225/ **	89,37"	23,62"	42,13"
U1540. * /250/ **	99,21"	23,62"	51,97"

A

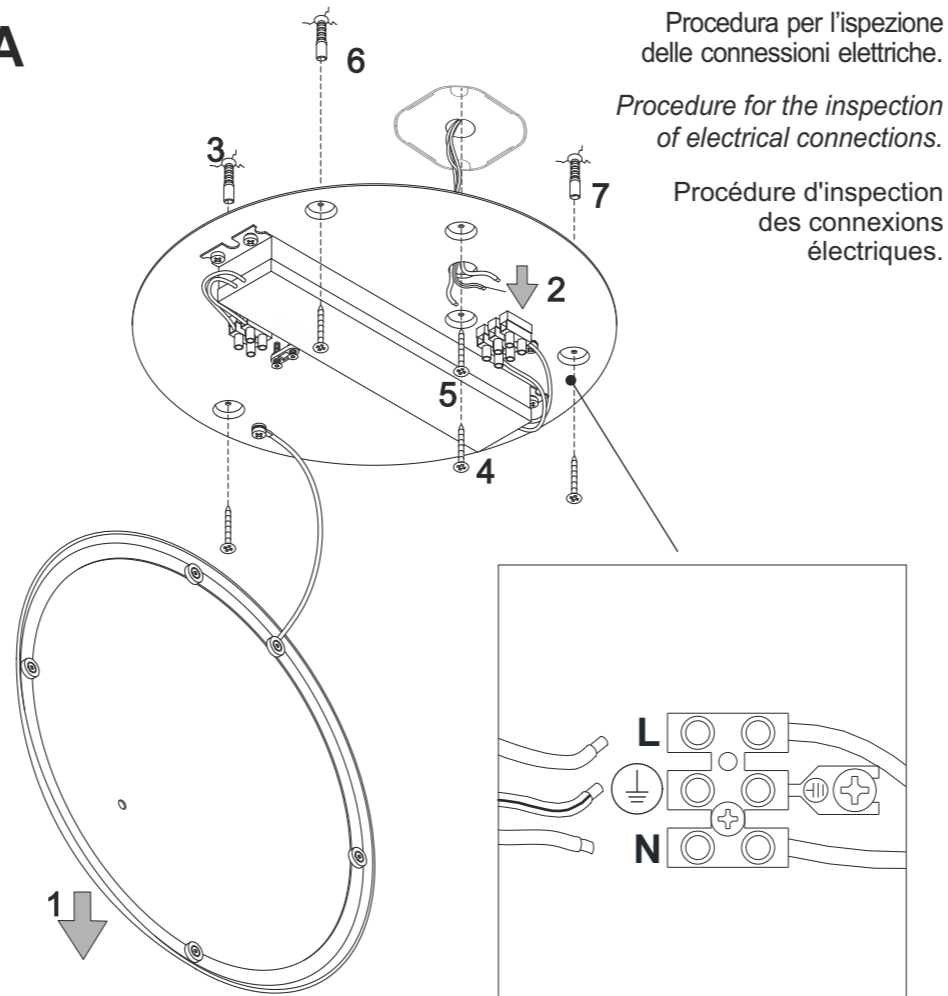

Procedura per l'ispezione delle connessioni elettriche.
 Procedure for the inspection of electrical connections.
 Procédure d'inspection des connexions électriques.

