

Code	<b>6362</b>
Description	iP67 walkable recessed radial spotlight with AISI 316L stainless steel flange, aluminum heat sink and 30 cm neoprene cable.
Year of production	2009
Typology	recessed floor, wall recess,
Material	INOX AISI 316L
Light Emission	<i>live</i>
IP grade	IP67
Allimentation	500mA - 2,9Vdc
Finishes	<b>.33</b> Brushed steel
Light source	<b>/W</b> 1.5W 221lm 4000K <b>/WW</b> 1.5W 210lm 3000K <b>/XW</b> 1.5W 199lm 2700k
Net weight	0,22 lb
	11,81 inch
	1,26 inch

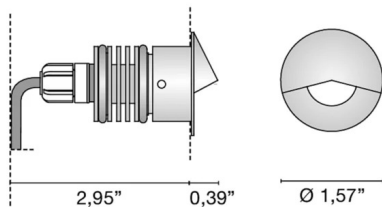

## ACCESSORIES

Plastic back case

**0216**

0,00 lb

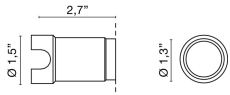

Kit: Drainage formwork + IP connector

**0220**

0,00 lb

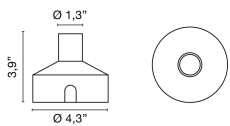

led direct current driver 500mA

**0127**

0,00 lb



led direct current driver 350mA

**0128**

0,00 lb

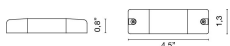

multipower dimmable led driver in continuous current

**0141/DIM**

0,00 lb

**.DIM** DIM



dALI multipower continuous current dimmable led driver

**0141/DALI**

0,00 lb

**.DALI** DALI



multipower dimmable led driver in continuous current

**0145**

0,00 lb



dALI multipower continuous current dimmable led driver

**0145/DALI**

0,00 lb

**.PUSH** PUSH

**.1-10V** 1-10V

**.DALI** DALI

